

NOTES:-

- VERGOLA FRAME: POWDERCOAT FRAME "SHALE GREY" COLOUR FINISH
- VERGOLA POSTS: POWDERCOAT "SHALE GREY" COLOUR FINISH
- FLASHING & GUTTER: MADE IN COLORBOND COLOUR "SHALE GREY"
- VERGOLA LOUVRES: MADE IN COLORBOND COLOUR "SHALE GREY"
- S/WATER: 75mm PVC DOWNPIPE TO EXISTING GUTTER & STORMWATER SYSTEM WITH PAINT COLOUR "SHALE GREY"

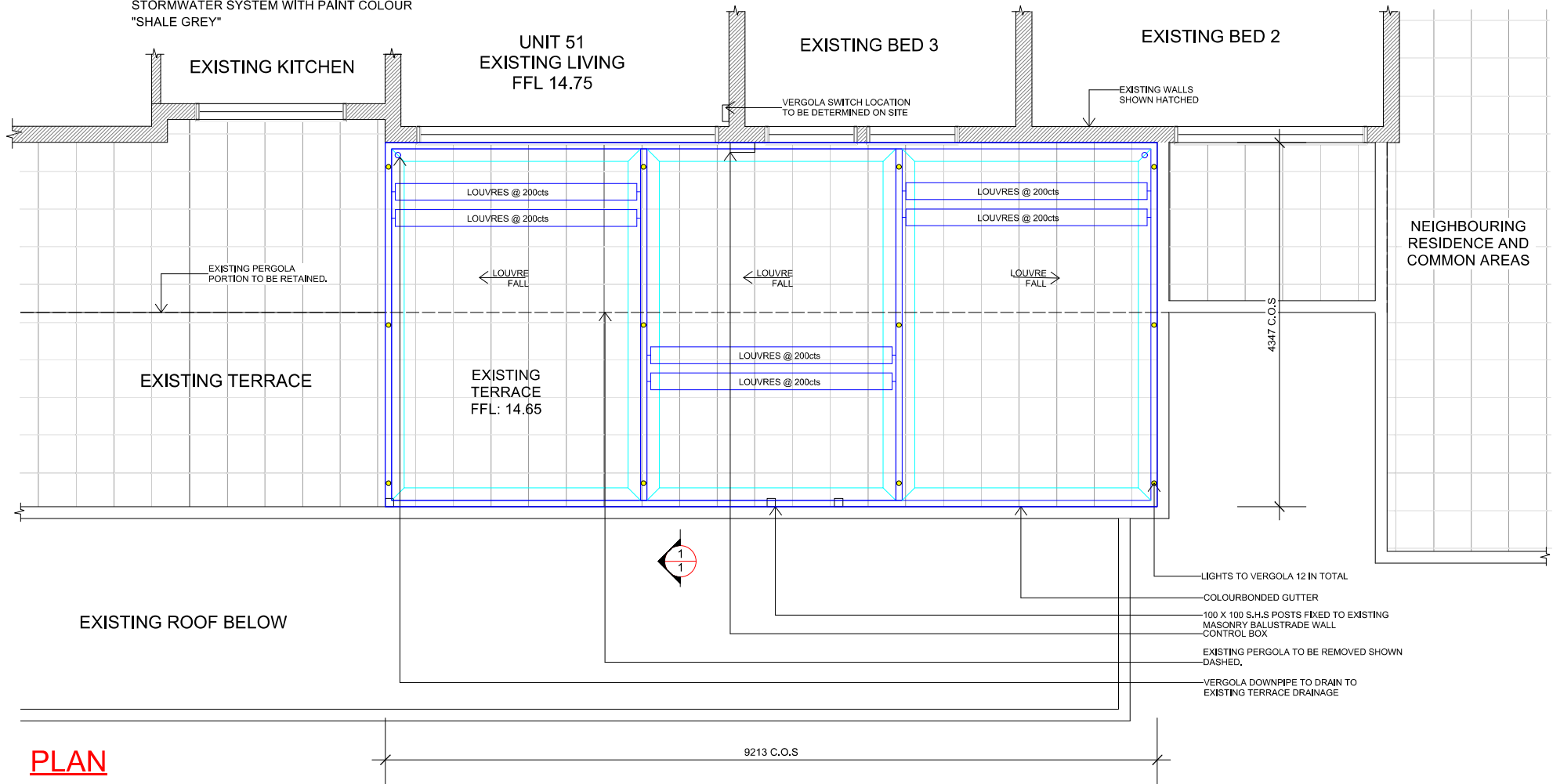

PLAN

SCALE 1:50

LEGEND:

- METAL-STEEL FRAME/"VERGOLA" - PAINTED-
- METAL DOWNPIPE/ GUTTERS - PAINTED



ALL MEASUREMENTS TO BE VERIFIED AT C/M

GENERAL NOTES

All work to be carried out in accordance with the Building Code of Australia, all Local and State Government Ordinances, relevant Australian Standards, Local Electricity and Water Authorities Regulations and all other relevant Authorities concerned.
 All timbers to be in accordance with SAA Timber Structure Code AS1720 and SAA Timber Framing Code AS 1684.
 All work to be carried out in a professional and workmanshiplike manner according to the plans and specification.
 Do not scale off the drawings unless otherwise stated and use figured dimensions in preference.
 All dimensions are to be checked and verified on site before the commencement of any work.
 Locate and protect all services prior to construction.



7 TEPKO ROAD TERREY HILLS NSW 2084
 TEL: (02) 9450 3300
 FAX: (02) 9450 3333

Project:

PROPOSED VERGOLA LOUVERED ROOF SYSTEM AT EXISTING UNITBLOCK

Client: **ZAC REES**

Address:

UNIT 51, 4 CHARLES STREET CANTERBURY - NSW - 2193

DATE DRAFTED 01-02-22	AMENDED DATE A - B - C -
SALES REP. B,P	SHEET No. 2 OF 6
DRAWN JGW	DATE SIGNED
DRAWING No. 19031	
SCALE. AS NOTED @A3	
CLIENTS SIGNATURE	